



Shadow
Assembly Guide



Shadow Assembly Guide





TABLE OF CONTENTS

1. Frameset Parts	4
2. Parts included in the BOX.....	5
3. Cables Map - Brakes.....	6
4. Cables Map - Front Derailleur	7
5. Cables Map - Rear Derailleur	8
6. Headset Installation	9
7. Di2 Battery Installation.....	10
8. Seatpost Installation.....	11
9. Front Derailleur Holder Installation.....	13
10. Frame Plugs Installation.....	14
11. TOOLBOX Installation	15
12. Bento BOX.....	16

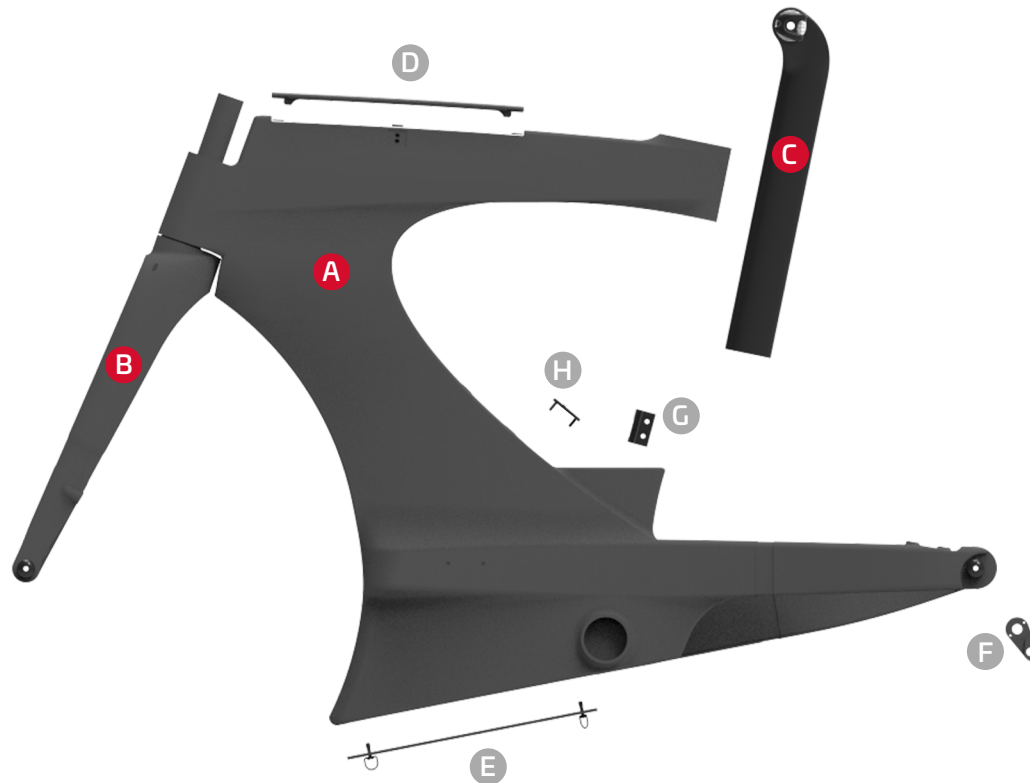

1. Frameset Parts

- A** 40T high-modulus carbon frame
- B** 40T high-modulus carbon Fork
- C** 40T high-modulus carbon Reversible Seatpost
- D** Bento Box rubber Lid
- E** TOOLBOX Lid
- F** Removable Rear Derailleur Hanger
- G** Removable Front Derailleur Hanger
- H** Di2 Junction Access Lid



2. Parts included in the BOX

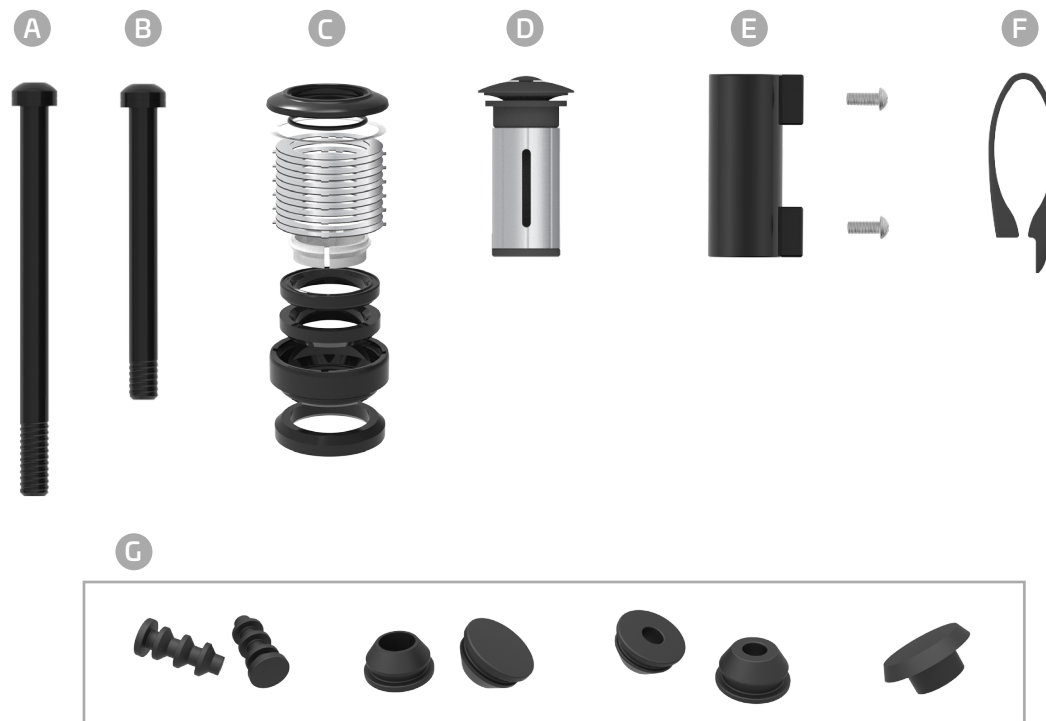

- A Rear thru axle
- B Front thru axle
- C Headset including Canecreek Viscoset
- D Expander
- E Di2 battery adaptor
- F Mini clamp
- G Grommets

Shadow Assembly Guide

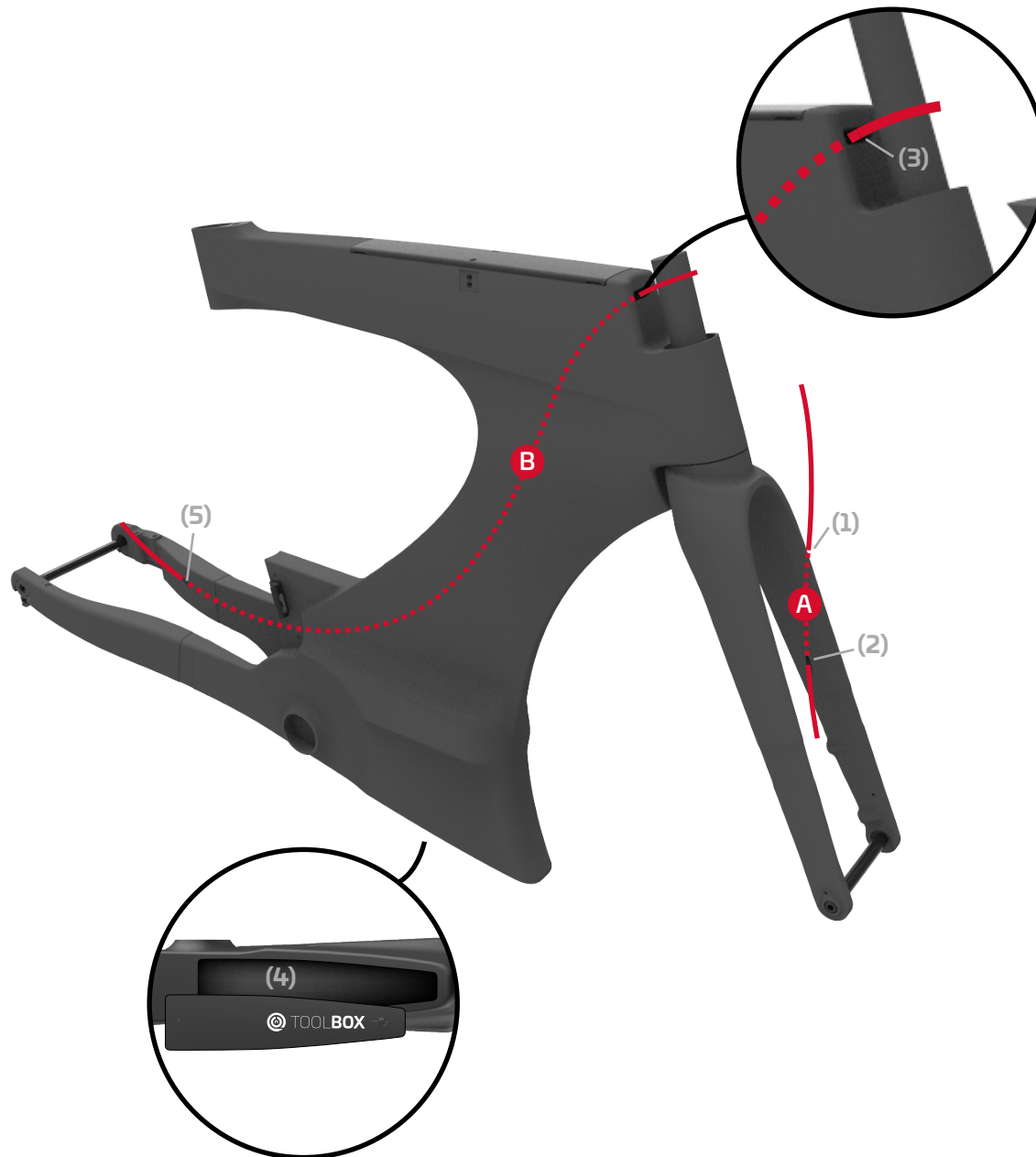

3. Cables Map - Brakes

A Front Brake Cable

Enter outer casing by hole located outside left side fork (1). Push casing inside until it reaches exit hole (2).

B Rear Brake Cable

Cable entry (3) is located behind stem. Thread the cable casing into hole until you can grab it through tool box opening (4), then guide it toward brake cable exit (5).



Pay attention to leave enough cable slack so you can pack the bike for travel and remove bars if needed.



No special parts or tools needed.

Shadow Assembly Guide

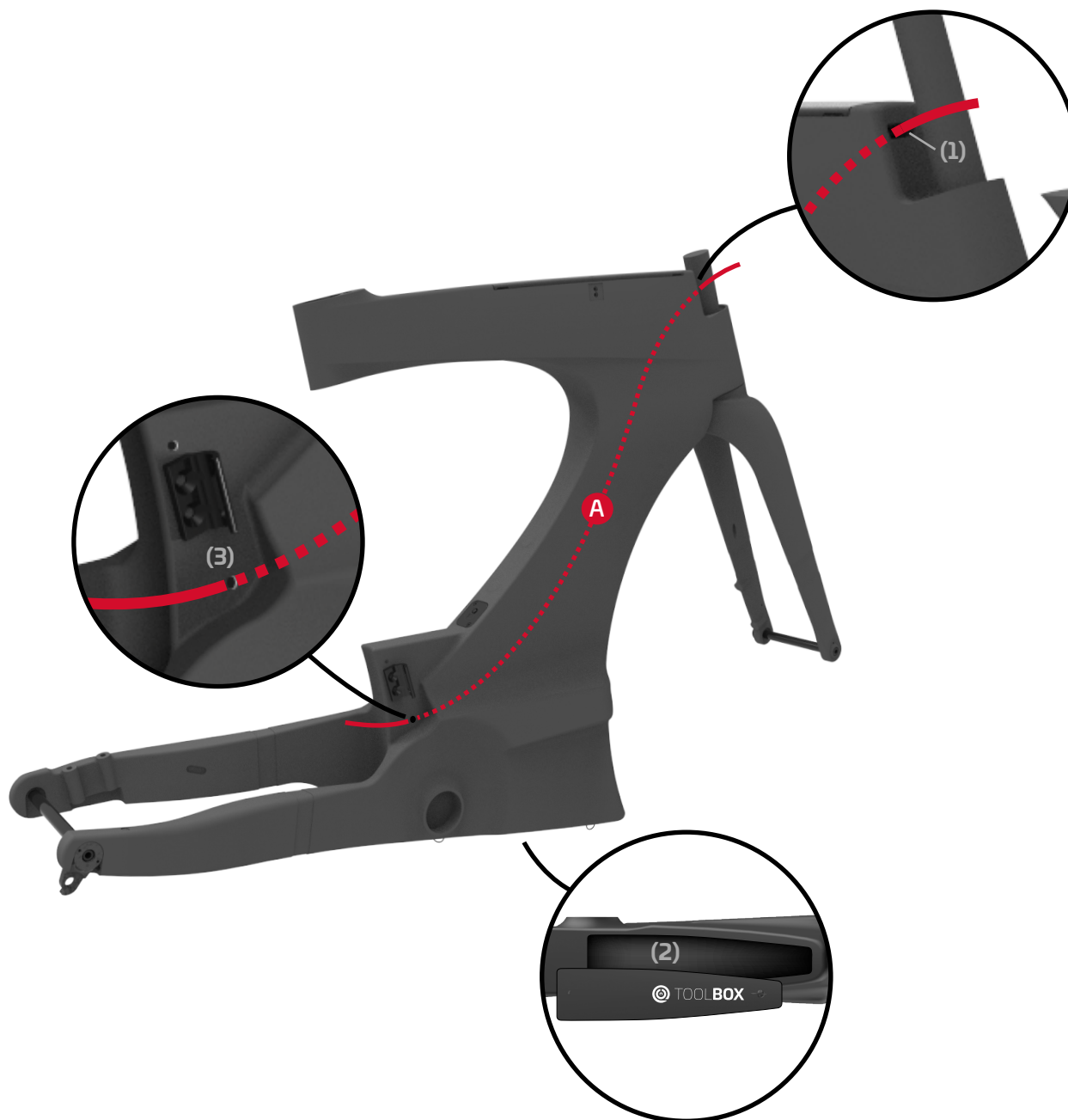

4. Cables Map - Front Deraillieur

A Map Front Deraillieur

Enter electric cable by hole located behind nose cone (1). Thread the electric cable into frame until you can grab it through tool box opening (2), then guide it toward brake cable exit (3).

This frameset is compatible with:

- All electric groups
- All 1By groups



No MECHANICAL Front Deraillieur possible.

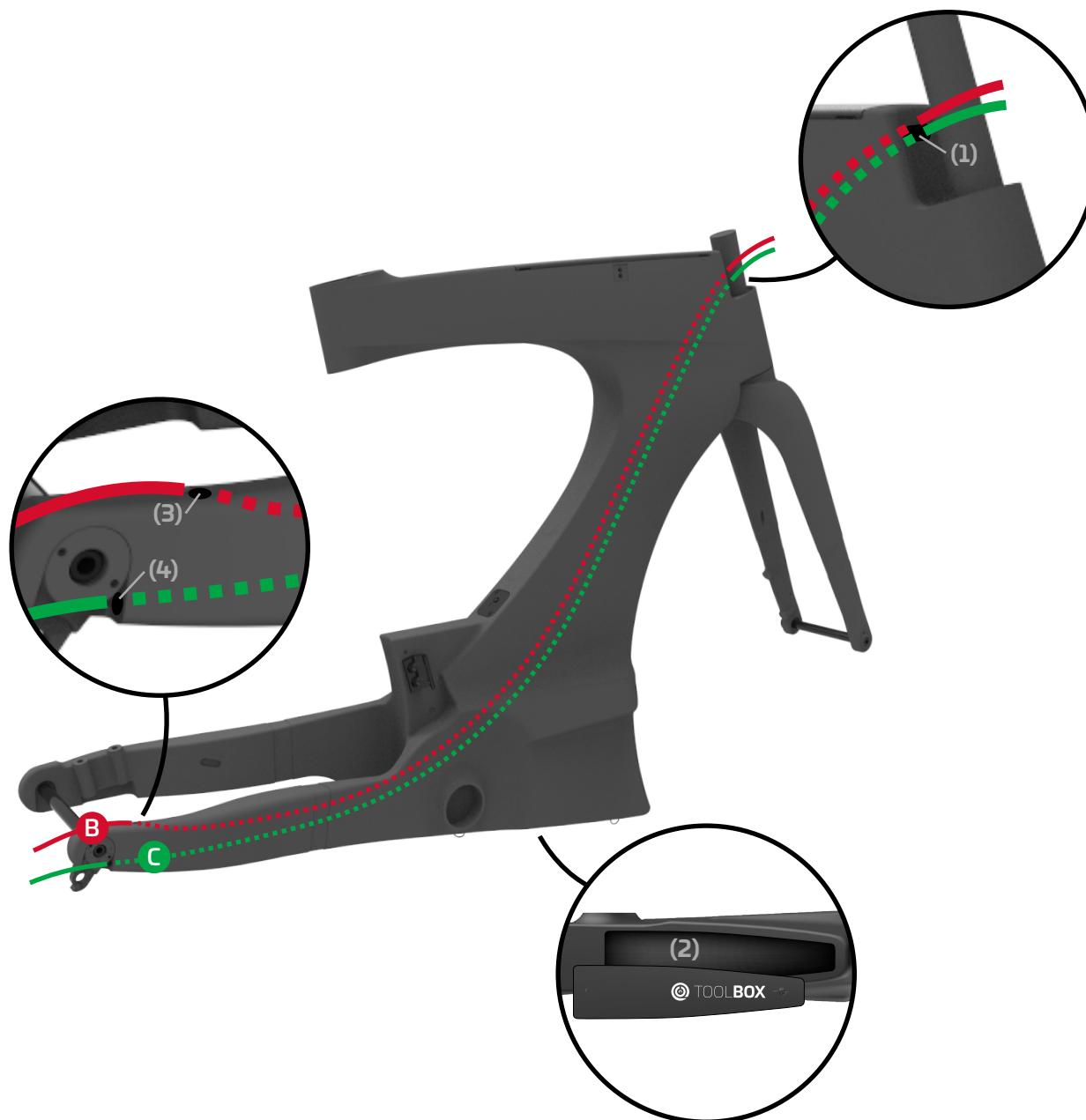

5. Cables Map - Rear Deraillieur

B Map Rear Deraillieur (mechanical)

Enter electric cable by hole located behind nose cone (1). Thread the electric cable into frame until you can grab it through tool box opening (2), then guide it toward brake cable exit (3).

C Map Rear Deraillieur (Di2)

Enter electric cable by hole located behind nose cone (1). Thread the electric cable into frame until you can grab it through tool box opening (2), then guide it toward brake cable exit (4).



You will need to remove the derailleur hanger to have access to the Di2 cable exit hole.

Shadow Assembly Guide

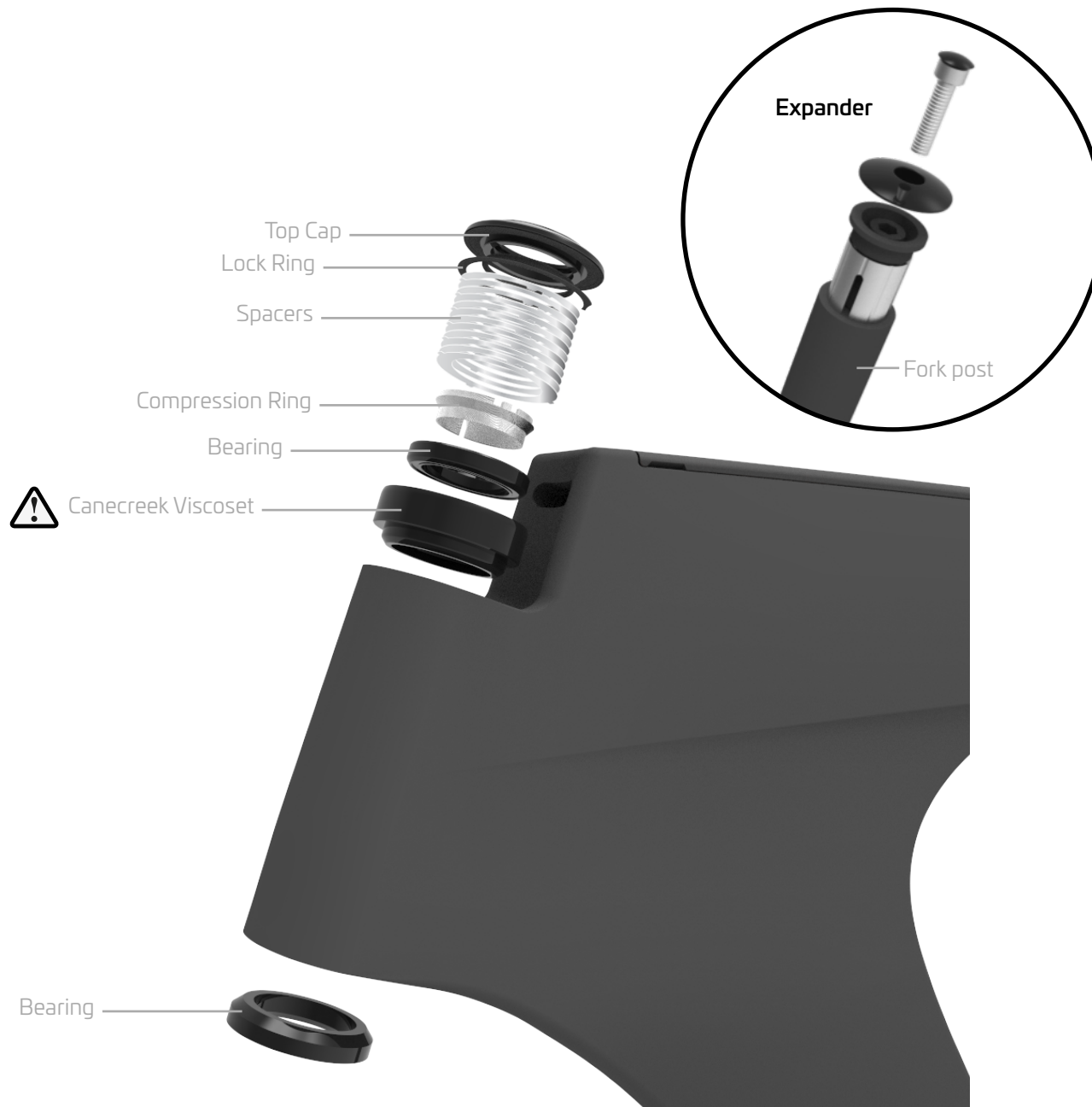

6. Headset Installation

The Ceepo Side Fork design is extremely unique and non-conventional. Because of the engineering behind the design, Ceepo provides a special "**Cane Creek Viscoset**" headset which is required to be used when assembling the Ceepo Shadow-R. Installing the special Cane Creek headset helps to ensure safe handling.



Please note that the use of any other headset is NOT authorized by Ceepo for installation on the Shadow-R or any other side fork equipped frameset.

Shadow Assembly Guide

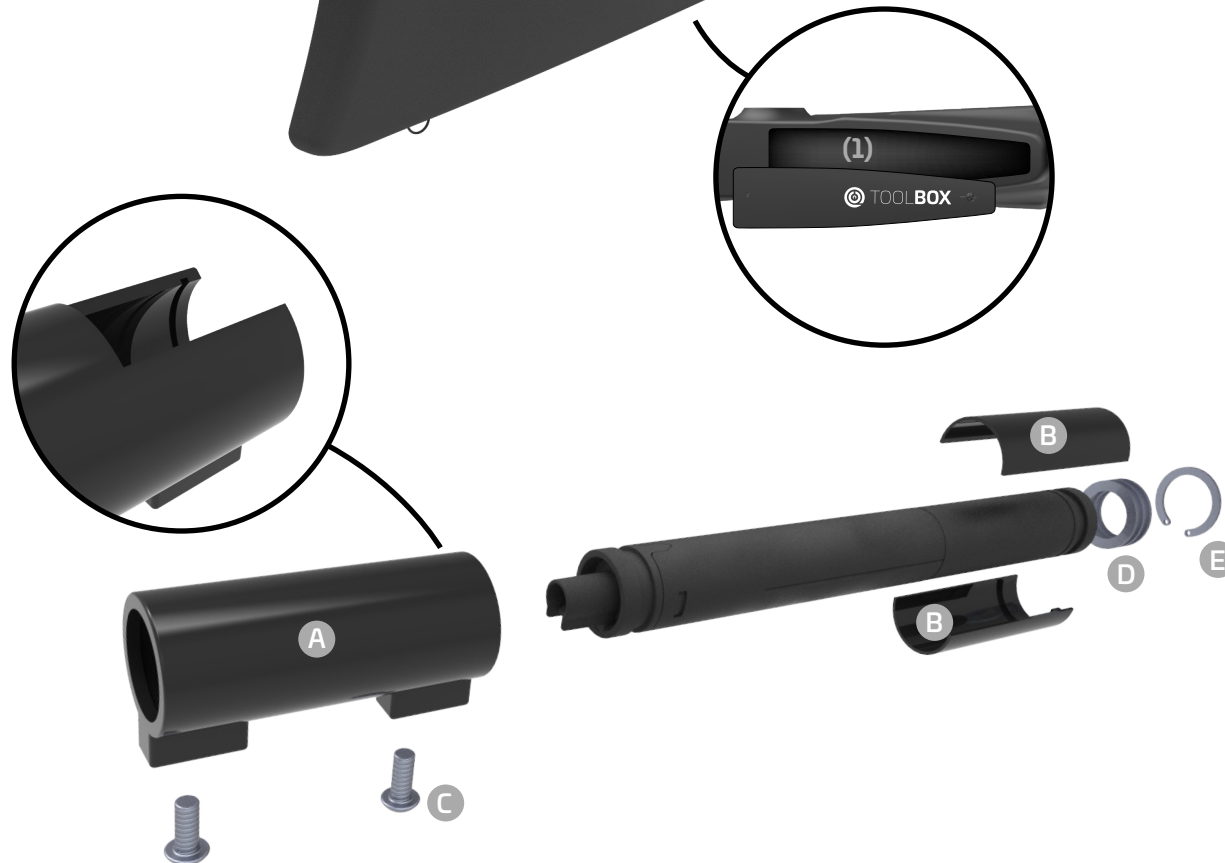

7. Di2 Battery Installation

Step 1

Secure battery in the provided battery holder.

Step 2

Insert the battery inside the frame using the toolbox opening (1). Hold the battery in place (inside) by hand while screwing from the outside.



We suggest to tape or tie wrap excess cable and Shimano junction to the battery before installation.

- A Di2 Battery Holder
- B Di2 Battery Collar
- C Adaptor Bolts
- D Washer
- E Internal Circlip

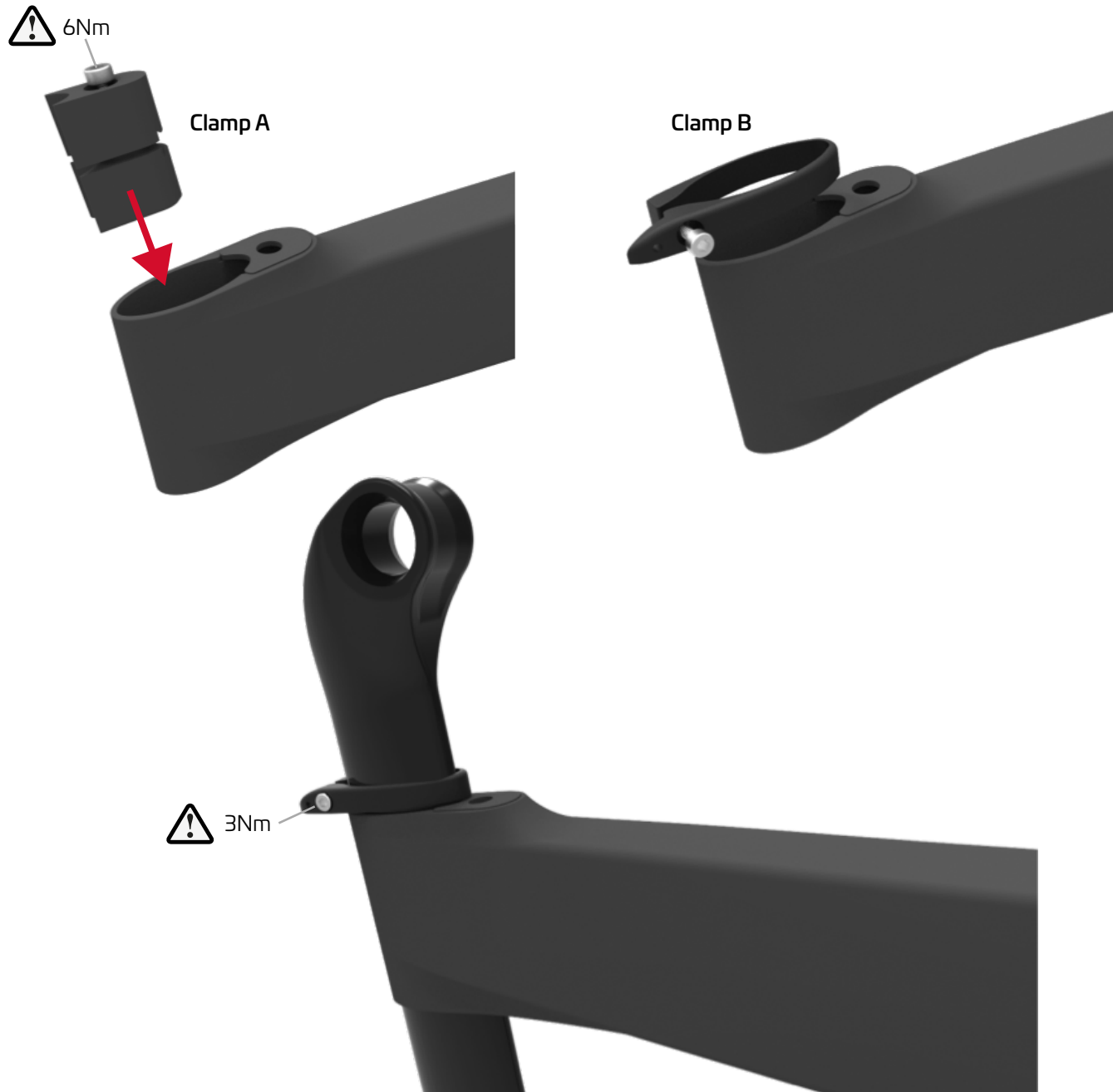

8. Seatpost Installation

Ceepeo reversible seat post is secured via 2 clamps.

Clamp A

Wedge type must be placed inside clamp pocket inside frame, paying attention to have access to Allen key bolt head so you can tighten it.

Clamp B

Our Mini-clamp is to be placed on seat post prior to Installation.



This small clamp remains on seat post when removing it for travel.

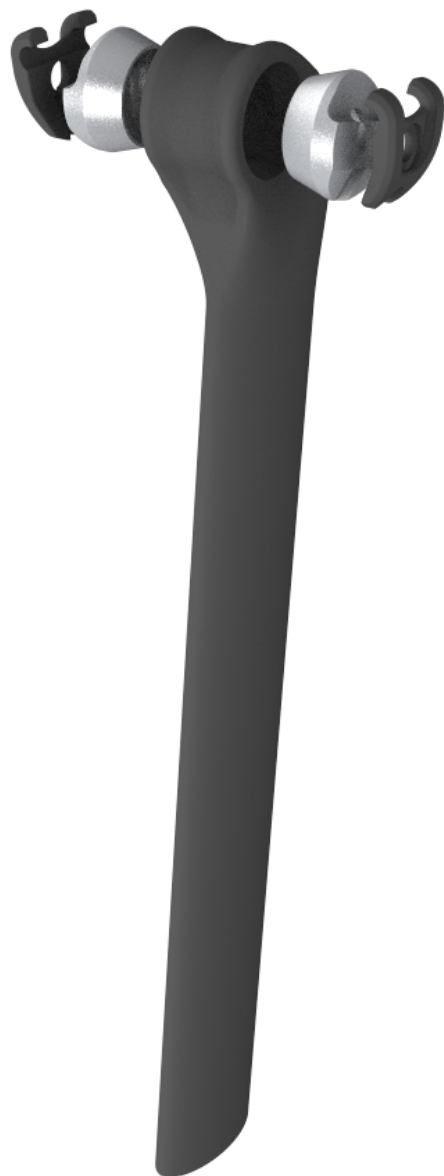

Shadow Assembly Guide



8. Seatpost Installation



Ceepeo new reversible seat post is only for Alu railed saddle. If for carbon railed saddle, please buy the special outer cap from Ceepeo.



Non-serrated for Infinite seat angle adjustment.



9. Front Derailleur Holder

Dual position



Will accept most chainrings ; including big oval ones.





10. Frame Plugs Installation

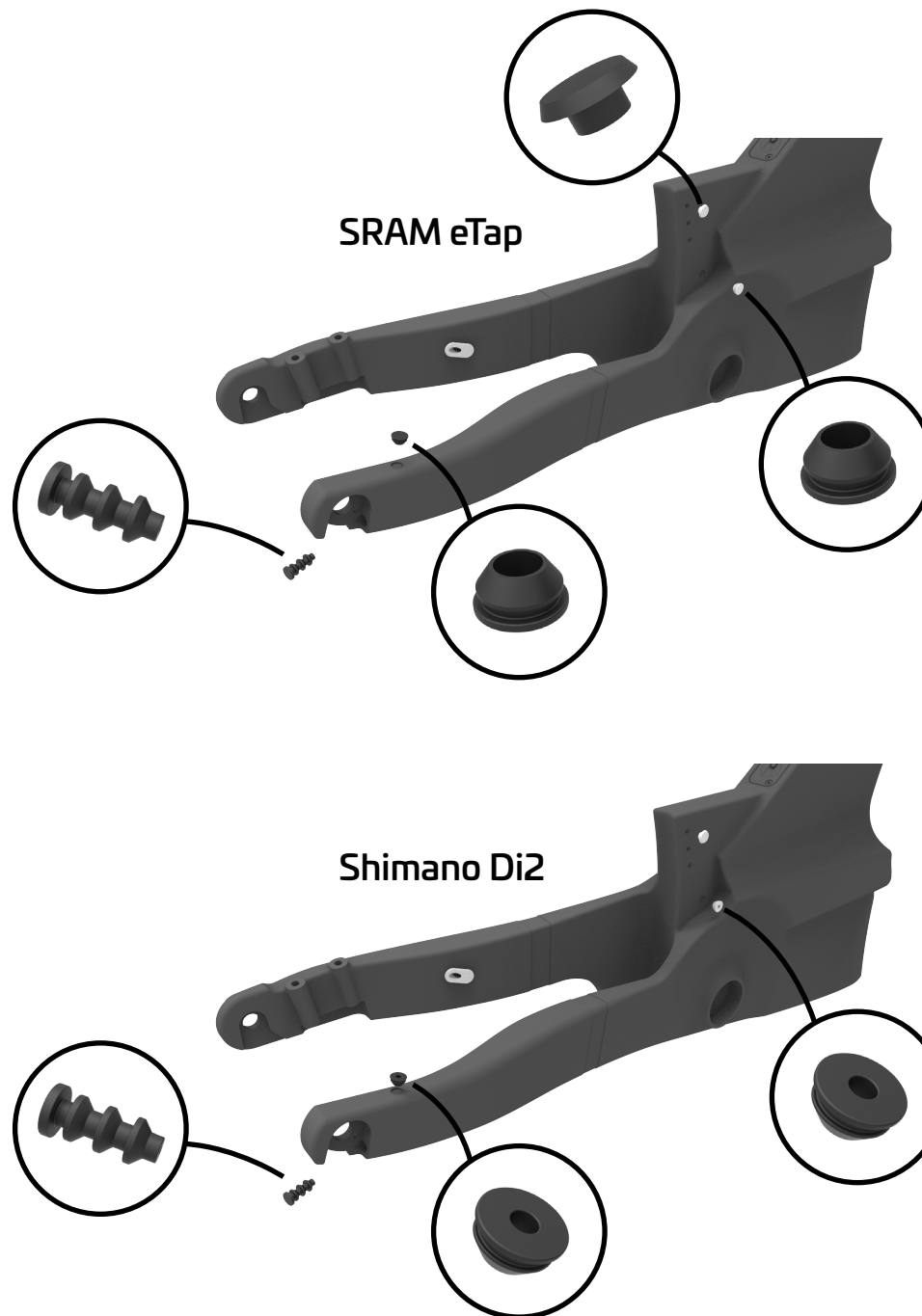

This PLUG should be already installed.

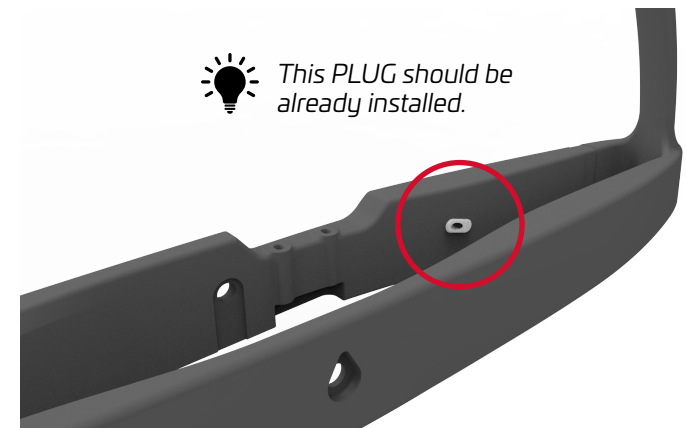

Shadow Assembly Guide



11. TOOLBOX Installation

Step 1

Velcro tool bag on the lid..

Step 2

Push it inside the frame and secure it using the 2 quick lock.



Pay attention to check quick lock engagement before riding. One side unlocked may result in loss of tool box riding, endangering rider and other cyclists along the way.

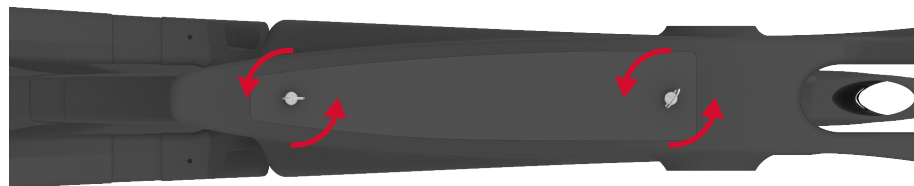

Tool Bag

Put tools inside mesh pocket

Insert Co2 cartridge inside the slots.

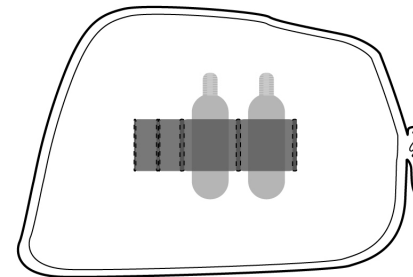
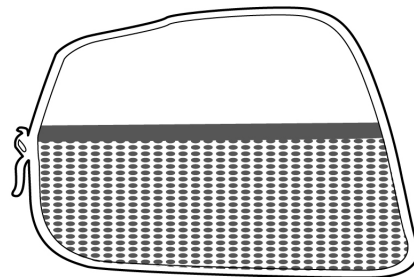

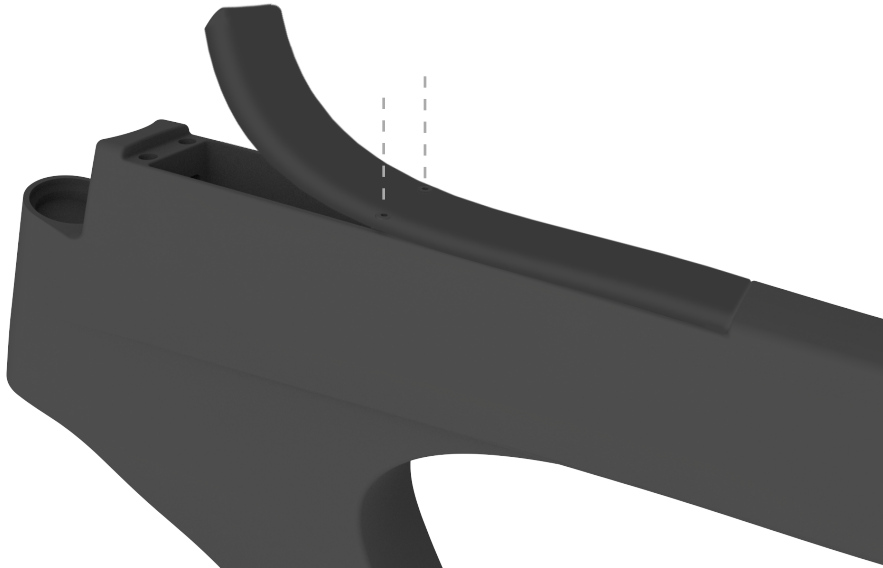

12. Bento BOX

Secure bento box cover at middle section.



*Bento is designed to open front and back
Magnets keep the cover closed while riding.*

