



Venom
2019 Assembly Guide



Venom

2019 Assembly Guide



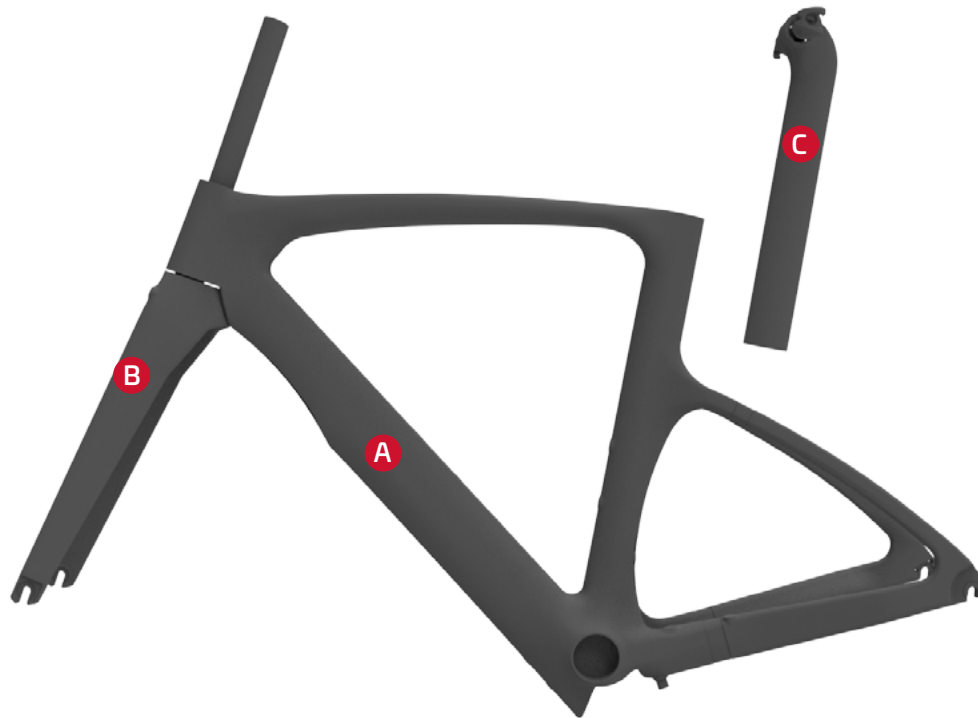

TABLE OF CONTENTS

1. Frameset Parts	4
2. Parts included in the BOX.....	5
3. Cables Map - Rear Brake	6
4. Cables Map - Mechanical.....	7
5. Cables Map - Electronic.....	8
6. Di2 Battery Installation.....	9
7. CO ₂ Adaptor Installation.....	10
8. Headset Installation	11
9. Seatpost Installation.....	12

Venom

2019 Assembly Guide



1. Frameset Parts

- A** 40T high-modulus carbon frame
- B** 40T high-modulus carbon Fork
- C** 40T high-modulus carbon Reversible Seatpost



2. Parts included in the BOX

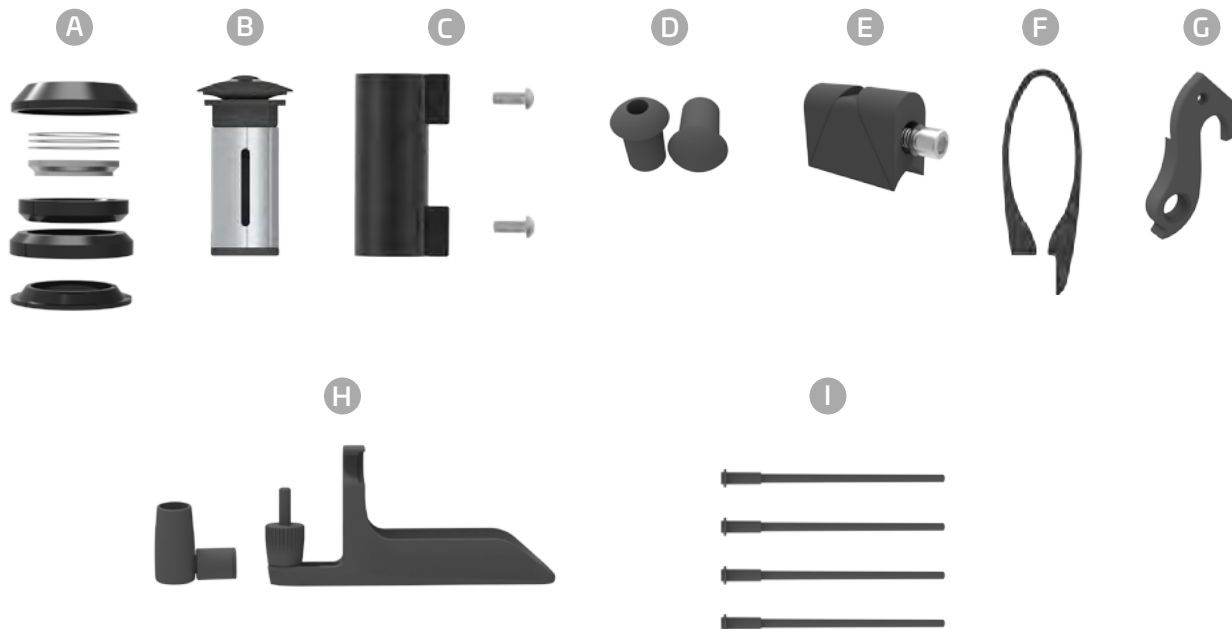

- A Headset
- B Expander
- C Di2 battery adaptor
- D Grommets
- E Clamp
- F Mini clamp
- G Grommets
- H CO2 Adaptor
- I Alloy Pipes

Venom

2019 Assembly Guide

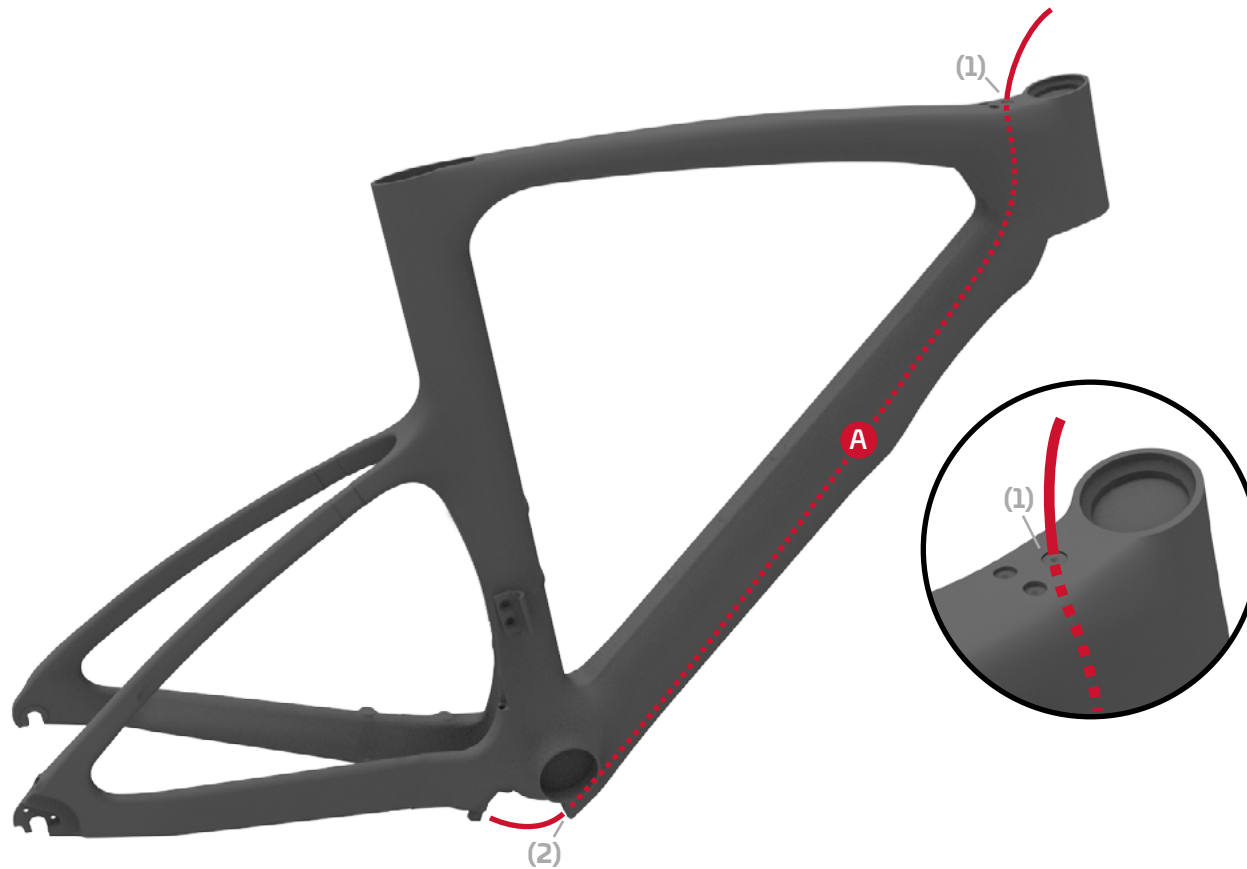

3. Cables Map - Rear Brake

A Rear Brake Cable

Cable entry **(1)** is located on top tube near the head tube. Thread the cable casing into the first center hole until you can grab it at the bottom down tube exit **(2)**, then guide it toward brake caliper.



No special parts or tools needed.

Venom

2019 Assembly Guide

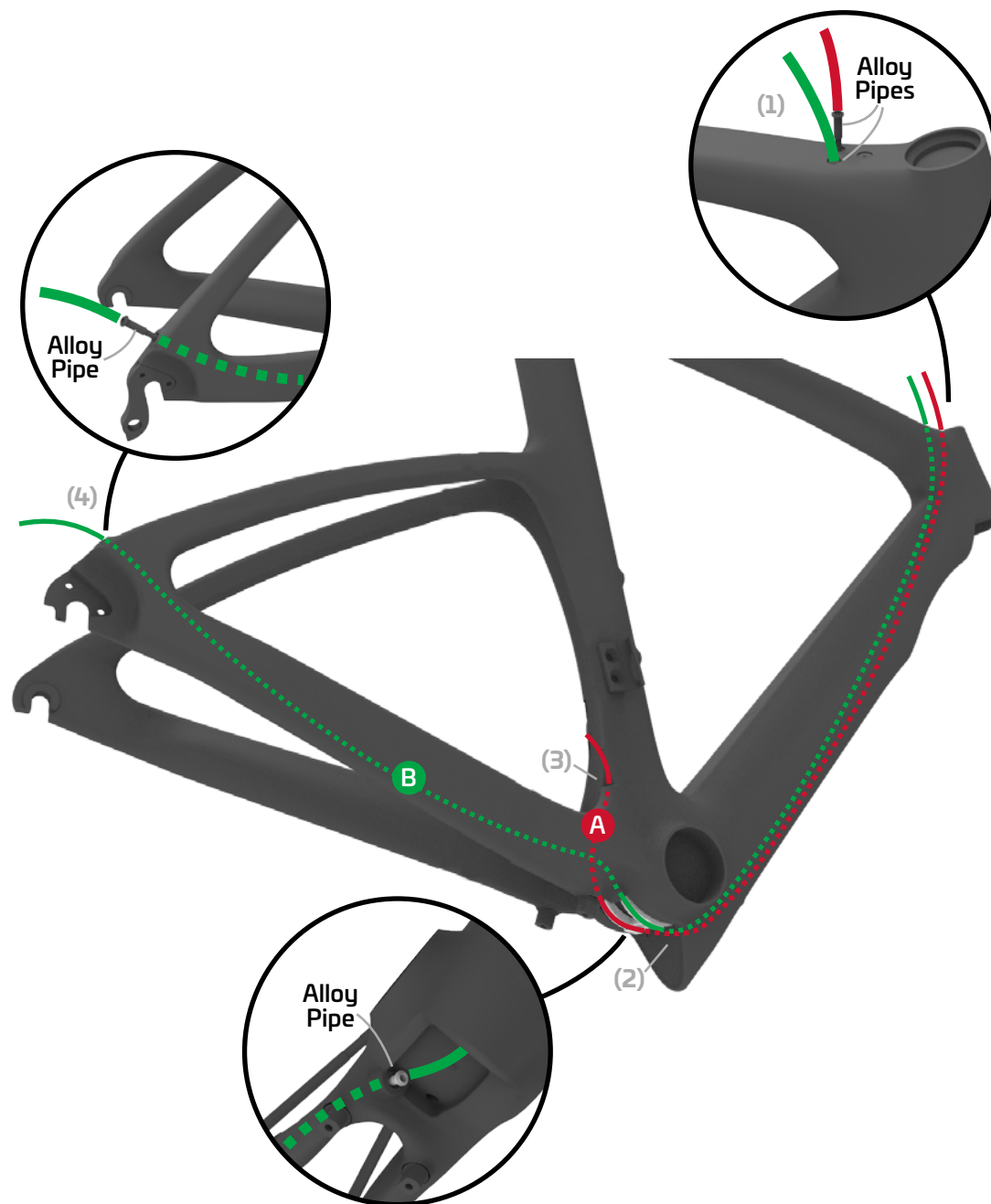

4. Cables Map - Shiftings

A Map Front Derailleur (mechanical)

Cable entry (1) is located on top tube near the head tube. Thread the cable casing until you can grab it at the bottom down tube exit (2), then guide it toward front derailleur exit hole (3).

B Map Rear Derailleur (mechanical)

Cable entry (1) is located on top tube near the head tube. Thread the cable casing until you can grab it at the bottom down tube exit (2), then guide it toward rear derailleur exit hole (4).

Venom

2019 Assembly Guide

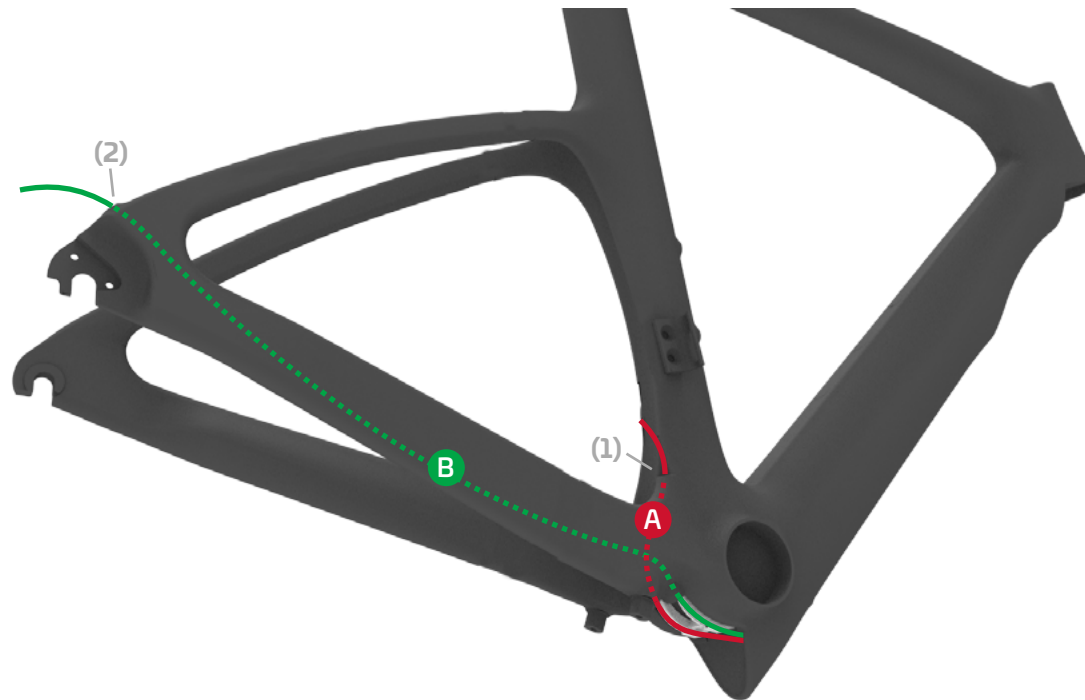

5. Cables Map - Shiftings

A Map Front Derailleur (electronic)

From the battery junction box, guide it toward front derailleur exit hole **(1)**.

B Map Rear Derailleur (electronic)

From the battery junction box, guide it toward rear derailleur exit hole **(2)**.

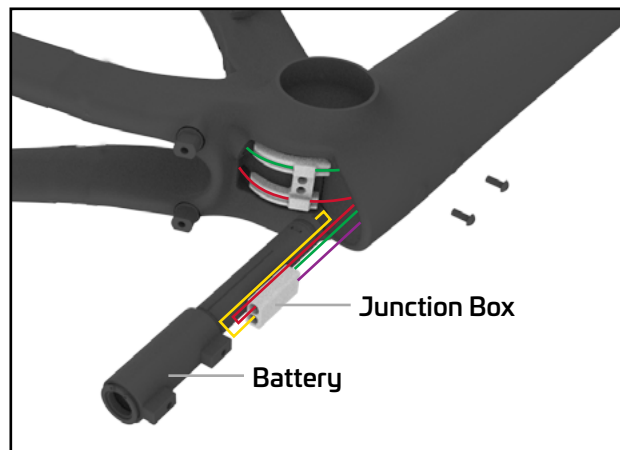
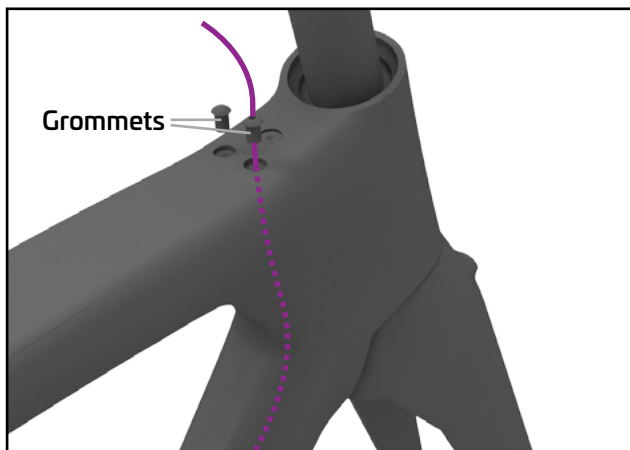

- Battery Wire
- Shifting Wire
- Front Derailleur
- Rear Derailleur



6. Di2 Battery Installation

Step 1

Secure battery in the provided battery holder.

Step 2

Hold the battery in place by hand while screws are put in place to hold battery assembly inside.



We suggest to tape or tie wrap excess cable and Shimano junction to the battery before installation.



- A Di2 Battery Holder
- B Di2 Battery Collar
- C Adaptor Bolts
- D Washer
- E Internal Circlip



7. CO₂ Adaptor Installation

Follow beside configuration.

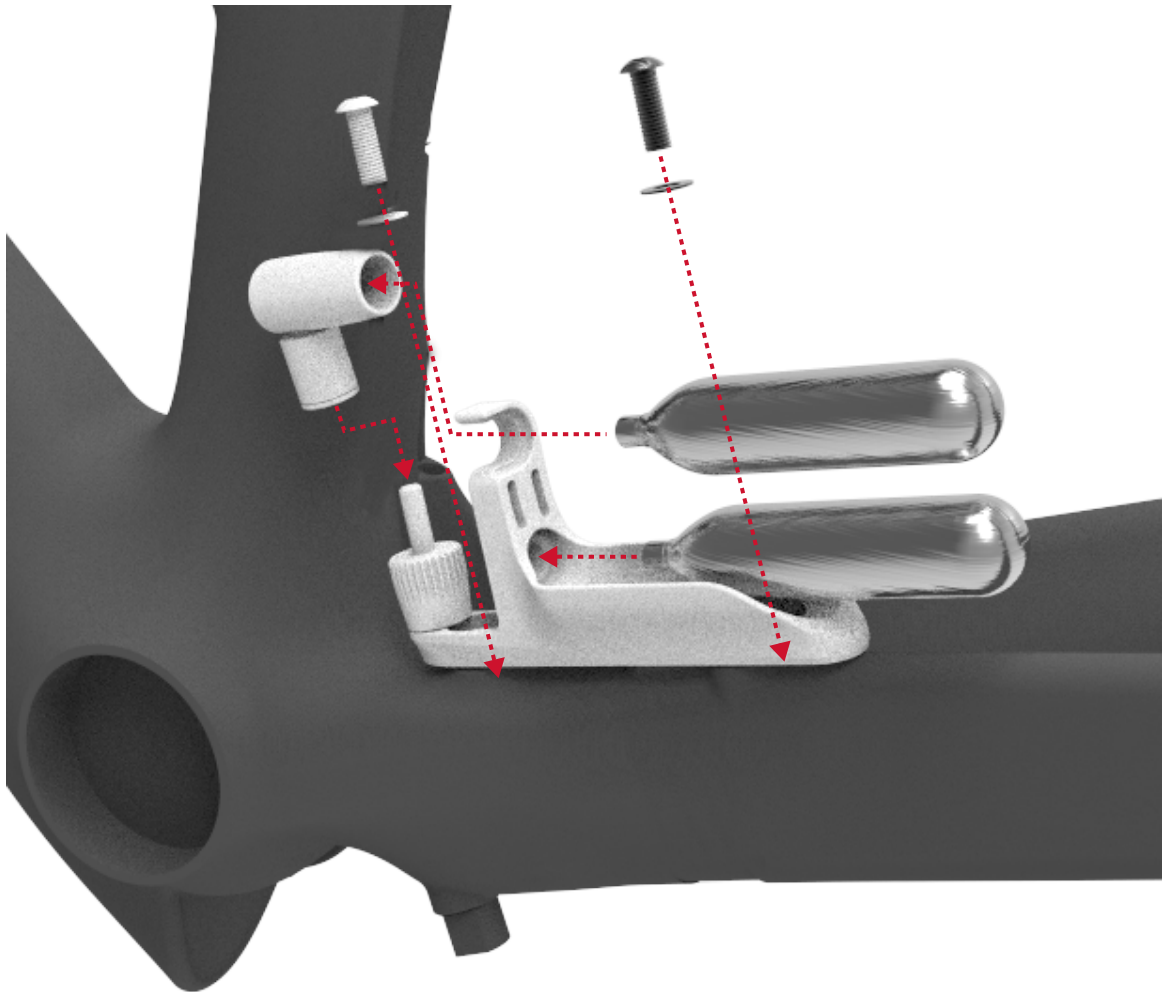

Venom

2019 Assembly Guide

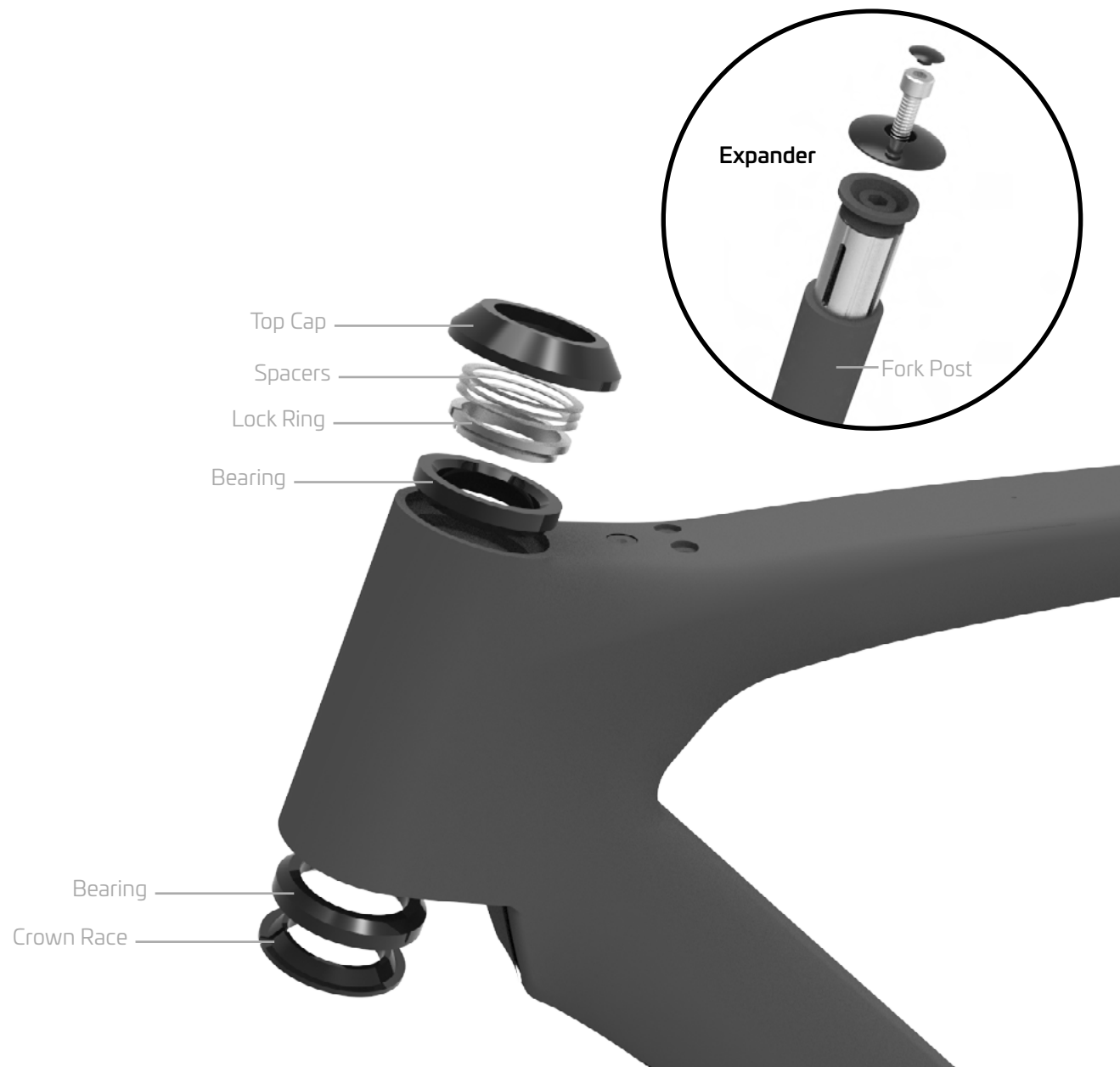

8. Headset Installation

Headset installation is standard.

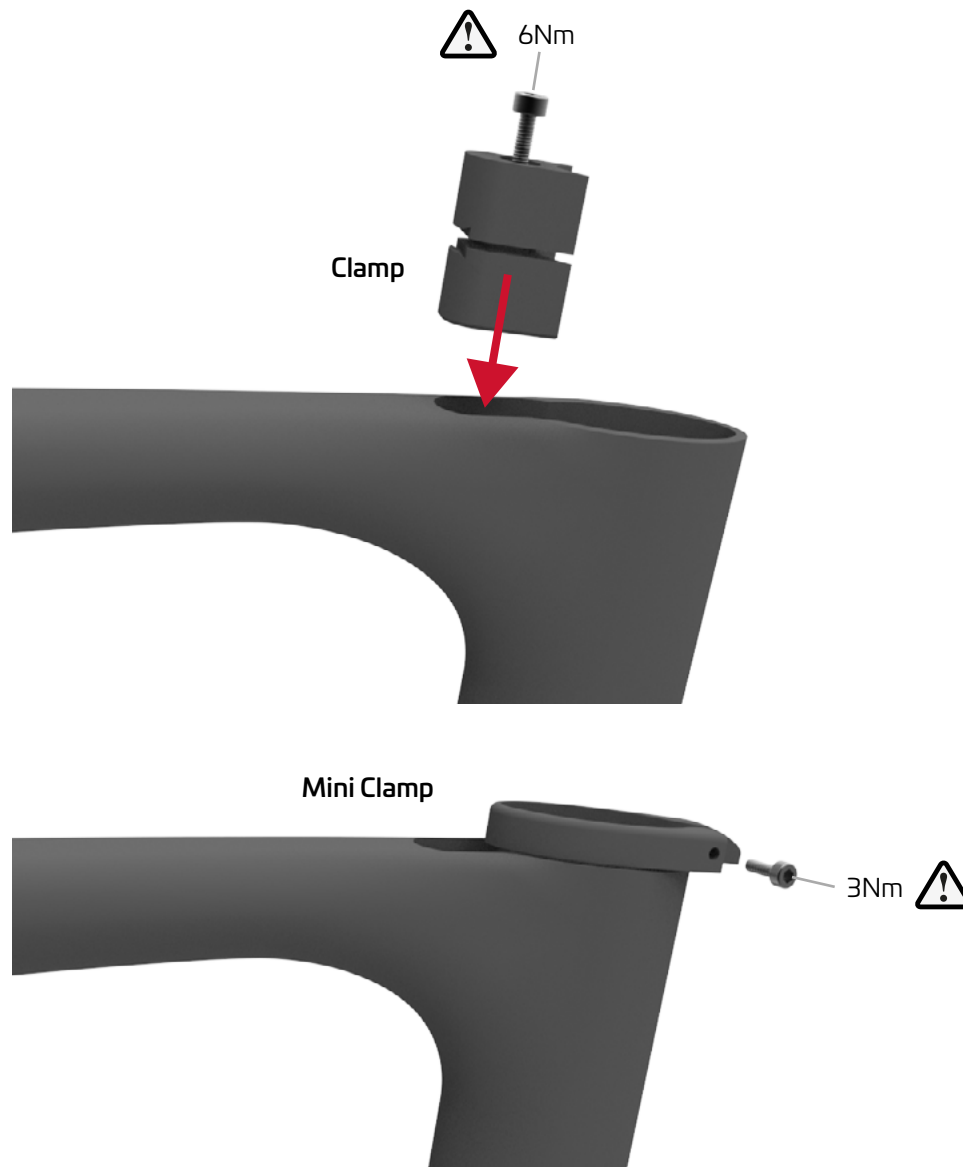

9. Seatpost Installation

Ceeppo reversible seat post is secured via 2 clamps.

Clamp

Wedge type must be placed inside clamp pocket inside frame, paying attention to have access to Allen key bolt head so you can tighten it.

Mini Clamp

Our Mini-clamp is to be placed on seat post prior to Installation.



The mini clamp remains on seat post when removing it for travel.